

Shoe EYELETS

NAVBHARAT Shoe Eyelets are available in Aluminium, Brass & Steel material with different finishes. Following Quick selection Chart will be helpful to select the Eyelets among the commonly used Industrial sizes in Footwear:

BASIC SHOE EYELETS

Product Name	Outside Diameter	Flange	3.00	3.50	4.00	4.50	5.00	5.50	6.00	6.50	7.00	7.50	8.00	Emb Washer	Neck Washer
200 eyelets	4.5	7.5	✓	✓	✓	✓	✓	✓	✓	✓	✓	✓	✓	✓	✓
300 eyelets	4.5	8.0					✓	✓						✓	
400 eyelets	5.0	9.0				✓	✓	✓	✓	✓				✓	✓
600 eyelets	5.5	9.8			✓	✓	✓	✓	✓	✓	✓			✓	✓
700 eyelets	6.5	11.8					✓		✓		✓			✓	✓
800 eyelets	8.0	13.5								✓				✓	
900 eyelets	10.0	16.5													✓

Product Name	Embossed Washer	Neck Washer
200 washer	✓	✓
300 washer	✓	
400 washer	✓	✓
600 washer	✓	✓
700 washer	✓	✓
800 washer	✓	
900 washer		✓



SAMPLE ARE AVAILABLE

CAN BE DEVELOPED ON REQUEST



Aluminum EYELETS

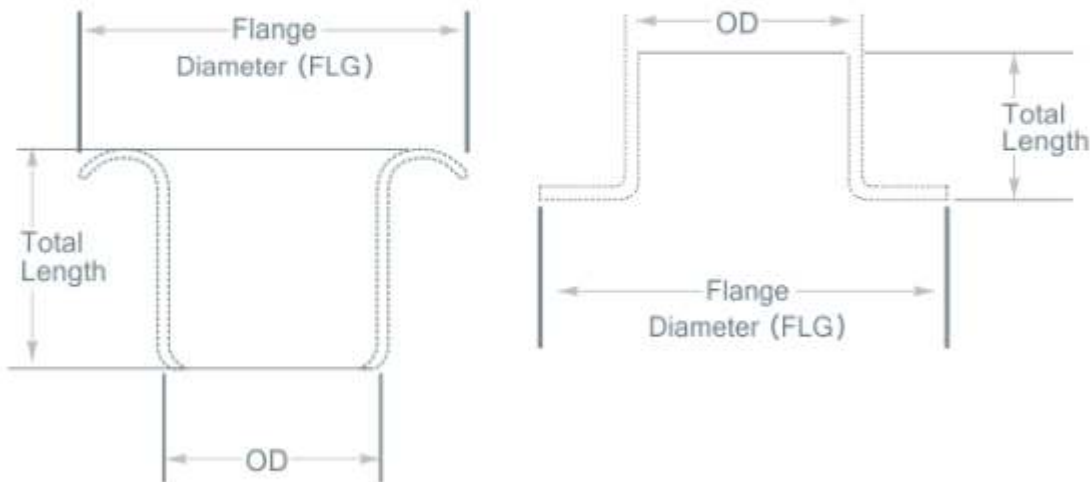

STANDARD TOLERANCES IN MM

Out Side Diameter (OD) : +/-0.10

Flange Diameter (ID) : +/-0.10

Total Length (T.HT) : +/- 0.20

APPLICATION :

Shoe Eyelets are mainly Used in Footwear.

METAL :

Aluminum, Brass, Steel

FINISH :

Available in Different Finished & Color as per requirement

STARTING METAL THICKNESS:

0.20,0.23,0.25,0.30



ALUMINIUM EYELETS

Product	O.D.	T.H.T	Flange
200 Med	4.7 x 4.3	5.0	7.5
200 Long	4.7 x 4.3	5.7	7.5
200 Neck Washer	5.2	3.5	7.5
400 Long	5.2 x 4.7	6.5	9.0
400 Neck Washer	5.7	3.8	9.8
600 Med	5.7 x 5.2	5.5	9.8
600 Long	5.7 x 5.2	6.5	9.8
600 Flat Flange	6.1	5.5	9.8
600 Neck Washer	6.5	3.8	9.8
700	6.5	6.5	11.8
700 Neck Washer	7.25	4.0	11.8
800	8.5	6.5	14.5
900	10.0	6.5	16.4

SPECIAL ALUMINIUM EYELETS

200 Short	4.7 x 4.3	4.5	7.3
400 XL	5.3 x 4.7	8.0	9.6
700 Short	6.5	8.0	11.8

BRASS EYELETS			
Product	O.D.	T.H.T	Flange
Small Invisible	3.45	2.8	6.5
Big Invisible	4.20	3.5	7.5
200 5.0 HT	4.5	5.5	7.5
200 6.0 HT	4.50	6.5	7.5
200 7.0 HT	4.5	6.8	7.5
200 Flat Flange	4.5	5.5	7.5
300 5.5 HT	4.5	5.5	8.0
300 Flat Head	4.5	5.5	8.0
400 5.0 HT	5.0	4.5	9.0
400 6.0 HT	5.0	5.8	9.0
400 6.5 HT	5.0	6.5	9.0
400 (10.00mm Flange)	5.0	5.8	10.0
600 5.0 HT	5.5	4.8	9.5
600 6.5 HT	5.5	6.0	9.8
600 7.0 HT	5.5	7.0	9.8
600 Flat Flange	5.5	6.5	9.8
700 6.0 HT	6.4	6.0	11.8
700 7.0 HT	6.4	7.0	11.8
700 Flat Flange	6.4	7.0	11.8
800 5.0 HT	8.6	5.0	11.8
800 6.5 HT	8.0	6.5	13.6
900 5.0 HT	10.1	5.2	16.5



Different shapes of Eyelets for footwear



HEXAGONAL EYELETS

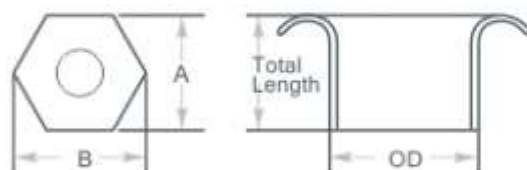

HEXAGONAL EYELETS			
Product	O.D.	T.H.T	Flange A X B
485	5	5.5	8.8 x 10
585 Ht. 6mm	5.2	6	10 x 11.3
585 Ht. 7.5mm	5.2	7.5	10 x 11.3
685	5.6	6	10 x 11.4

Customised logo Eyelets



CUSTOMISED EYELETS

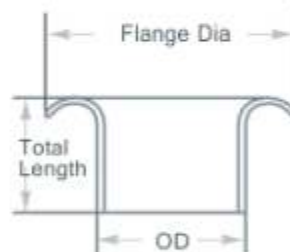

NAMED EYELETS			
Product	O.D.	T.H.T	Flange
200 LINE EMBOSS	4.5	5.5	7.5
400 EMBOSS	5.0	6.0	9.8
600 EMBOSS	5.5	6.0	11.8
585 EMBOSS	5.1	7.5	10.9x12.3

NECK WASHER

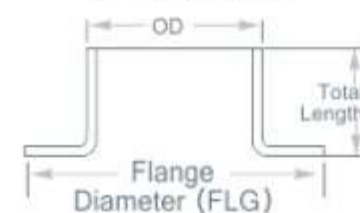

NECK WASHER			
Product	O.D.	T.H.T	Flange
200 Neck Washer	5.1	3.8	7.5
400 Neck Washer	6.0	3.5	9.8
600 Neck Washer	6.0	3.6	9.8
700 Neck Washer	7.0	4.0	11.8

EMBOSS WASHER

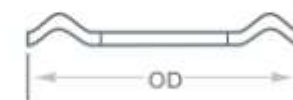

EMBOSS WASHER			
Product	O.D.	T.H.T	Flange
200 Emb Washer			7.7
400 Emb Washer			10.2
600 Emb Washer			13.8
700 Emb Washer			13.6

Shoe Hooks

APPLICATION :

Hooks are mainly used in Safety footwear.

METAL:

Steel, Brass

FINISH:

Nickel, Brass, Natural, Black

STARTING METAL THICKNESS:

0.40,0.50,0.60,0.70mm

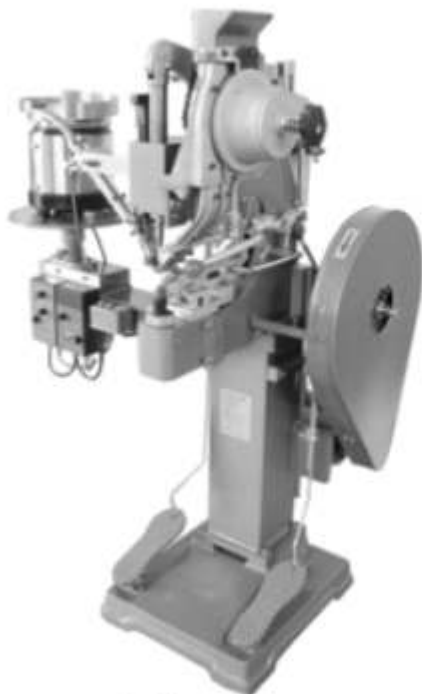

■ HM-608HK



HM-608HK RIVETING MACHINE SPECIALLY DESIGNED FOR HOOK RIVETS

Throat Depth	10"
Power	½ HP
Stroke	60 m/m
Net Weight	180 kg
Gross Weight	250 kg
Suitable Hardware	Hook-Rivets
Suitable Diameter	7013 mm

Setting machine specially designed for the hook-rivets. Double side automatic feeding.